

# Tilt adapter

Avant tilt adapter is mounted between the attachment and the loader's attachment coupling plate. With it the attachment can be tilted sideways, and makes it possible to:

- Make different forms to the ground with a bucket or leveller
- Keep pallet fork level when you are driving on surfaces with gradient
- Load pallets that are on uneven ground
- Level ground on uneven surfaces
- With the 90 degree tilt adapter rotate the attachment as much as 90°

There are two tilt adapters available:

- Tilt adapter with max. 12,5 degree tilting in both directions. It is intended for buckets, leveller and pallet fork – for jobs where tilting is a must but the tilting angle doesn't have to be big
- Tilt adapter with max. 90 degree rotation, or 45 degree tilting in both directions. It is useful in applications where the attachment needs to be rotated more in order to get the job done: with grabbing tool (rotating of barrels etc.), rock drill, artificial turf attachment (to fit through narrow doors) etc.

The hydraulic cylinder of the 90 degree tilt adapter can be mounted in two different positions, which gives two tilting angles: either 45° tilting in both directions, or 90° rotation in one direction. The tilt adapter is intended mainly for non-hydraulically operated attachments, but with the optional second auxiliary hydraulics outlet in the front it is possible to mount also hydraulically driven attachments like a 4 in 1 bucket, pallet fork with hydraulic fork adjustment, grabbing tool, artificial turf attachment and rock drill at the same time.

- **Makes it possible to tilt the attachment sideways and e.g. grade the ground with a bucket or leveller, or load pallets on uneven ground with pallet fork**
- **Mounts between the attachment and the quick attach plate of the loader**
- **Two models: with max. ± 12,5° tilting or with max. 90° / ± 45° rotation**



Max. tilt	+/- 12,5 deg	90°, or ± 45°
Weight	65 kg	85 kg
Product no	A34148	A36505

220	225	225LPG	313S	320S	320S+	420	423	520	523	525LPG	528	530	R20	R28	R35	630	635	640	745	750	755i	760i	e5	e6	

Very compatible
  Compatible
  Incompatible

# Drawbar

**New**

The rigid drawbar is 1000 mm long and equipped with a trailer coupling for 50 mm ball hitch. It mounts on the attachment's quick attach plate and enables towing of the attachment with the loader. This can be useful with certain attachments, like the roller compactor. Height of the drawbar can be adjusted so that it fits on all models; both on Avant 200 series with lower ball hitch and on bigger Avant models. The loader must be equipped with the 50 mm ball hitch.



- **Rigid drawbar, equipped with trailer coupling for 50 mm ball hitch**
- **Mounts on the attachment's quick attach plate – enables towing of the attachment with the loader**
- **Manual height adjustment, for ball hitches on different Avant models**

Length	1000 mm
Weight	25 kg
Product no	A37481

220	225	225LPG	313S	320S	320S+	420	423	520	523	525LPG	528	530	R20	R28	R35	630	635	640	745	750	755i	760i	e5	e6	

Very compatible
  Compatible
  Incompatible

# Hydraulic side shift adapter

**New**

The hydraulic side shift adapter offers easy, stepless side shift of attachment, operated from the driver's seat. The solid and robust design features strong sliding guides which can also be lubricated. The quick attach plate on the adapter can be mounted in three different positions: on the left or on the right or in the middle of the adapter. This gives three different side shift options: 500 mm side shift to the right or to the left, or 250 mm side shift in both directions.

If a hydraulic attachment – 4 in 1 bucket, flail mower, cold planer etc. – is mounted on the side shift adapter, the loader must be equipped with the optional second auxiliary hydraulics outlet in the front, so that the attachment hoses are mounted on the multi connector and the side shift adapter hoses on the optional second outlet.



- Easy, stepless hydraulic side shift of the attachment, operated from the driver's seat
- Side shift max. 500 mm to the right or the left, or 250 mm in both directions, depending on the mounting of the adapter's attachment plate
- Max. load 1.000 kg

Options

Width	1270 mm
Height	434 mm
Length	218 mm
Weight	115 kg
Product no	A37235

220	225	225LPG	313S	320S	320S+	420	423	520	523	525LPG	528	530	R20	R28	R35	630	635	640	745	750	755i	760i	e5	e6	

Very compatible      Compatible      Incompatible

# Side shift adapter

Side shift adapter is a rigid adapter plate. When mounted on the side shift adapter, the attachment is 400 mm or 600 mm to the side from the centerline.

The 600 mm side shift adapters are equipped with two quick attach brackets for mounting on the loader's quick attach plate. This means that they can be mounted on the loader so that the attachment is 600 mm on the side, or in the center without side shift.

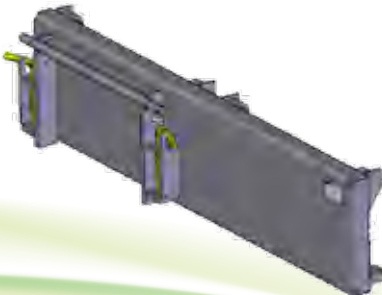

Side shift adapter	400 mm, right	600 mm, right	600 mm, left
Width	930 mm	1150 mm	1150 mm
Height	265 mm	265 mm	265 mm
Length	157 mm	157 mm	157 mm
Weight	37 kg	45 kg	45 kg
Product no	A34893	A37097	A37166

220	225	225LPG	313S	320S	320S+	420	423	520	523	525LPG	528	530	R20	R28	R35	630	635	640	745	750	755i	760i	e5	e6	

Very compatible      Compatible      Incompatible

# Hydraulic manifolds to attachment multi connector

**New**

There are various hydraulic manifolds with different functions available which mount on the attachment multi connector:

## Options

### Flow divider valve

This manifold reduces the auxiliary hydraulics oil flow from the loader to the attachment by 50 %. This means that the attachment movement speed is 50 % slower, which can be useful in situations where a slower attachment speed is required, without reducing loader engine revs too much.

Product no.           A421684



### 2-way adjustable pressure relief valve

The pressure relief valve releases the excessive pressure which can be generated in the attachment if it is mishandled by e. g. pulling it too much with the loader. The opening pressure of the relief valve can be adjusted. It controls both the pressure from the loader to the attachment and the pressure in the attachment. In addition, there is a third, feed/tank line which is useful when the attachment is equipped with hydraulic cylinder(s).

Product no.           A422104



### Pressure gauges

The hydraulic pressures in the attachment, in both lines, are easy to check with these two pressure gauges. They mount on the A422104 2-way adjustable pressure relief valve. A422104 is not included.

Product no. A422475



### Double check valve

The double check valve is a lock valve which prevents the movements of the attachment's hydraulic cylinder, in both directions, when the attachment is not in operation. This can be useful for instance with the log grab when handling delicate objects like kerb stones etc. – the lock valve makes sure that the grab cannot open.

Product no.           A422968



# Adapters for mounting of 200 series 1 attachments on 200 series 2, and vice versa

There are five different adapters available, between std. Avant attachment bracket (Avant 200 series 2, manufactured from 2016-) and 200 series 1 (manufactured 2003-2015):

**Case 1:** Adapters with Avant 200 series 1 (216/218/220) attachment bracket:

- 1) Weld-on adapter plate with 200 series 1 attachment bracket A46529
- 2) Adapter A33126 that bolts on std. Avant attachment bracket (adapter colour is grey)
- 3) Adapter A36826 that mounts on std. Avant attachment bracket with quick release pins like the attachment coupling plate of the machine. The 200 series 1 attachment bracket is welded on the other side of the adapter (adapter colour is green). This adapter can be useful when you have several attachments with std. Avant attachment bracket and don't want to mount the A33126 bolt-on adapter on all of them; or when you need to change the attachments often.

For the hydraulic hoses of 200 series 1 attachments you need the A416760 flat face coupling kit. The kit includes 3 pcs flat face quick couplings, their protective caps and the "parking" on the attachment for the attachment hydraulic hoses.

**Case 2:** You have a 200 series 2 machine (Avant 220/225 - or other Avant model with std. Avant attachment coupling plate), and want to mount on it attachments with 200 series 1 attachment bracket. There are two different adapters available:

- 1) Adapter A36825 that bolts on 200 series 1 attachment (adapter colour is grey)
- 2) Adapter A35590 that mounts on 200 series 1 attachment with quick release pin, like the attachment coupling plate of 200 series 1. The std. Avant attachment bracket is welded on the other side (adapter colour is green).

This adapter can be useful when you have several 200 series 1 attachments and don't want to mount the A36825 bolt-on adapter on all of them; or when you need to change the attachments often.

- 3) Adapter A419705 for hydraulic hoses: on multi connector of the machine, to 200 series 1 attachments with flat face couplings



A419705

- 4) A412129 Hose extension kit, 3 pcs, L=800 mm

\* For those 200 series 1 attachments which require longer hoses when mounted on 200 series 2, for example: high tip bucket, mini digger, log grab, auger, lawn mower, collecting mower, all-round grapple



A46529



A33126



A36826



A416760

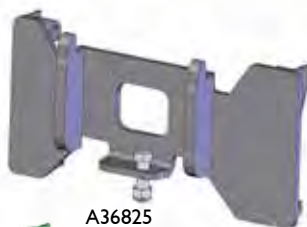

A36825

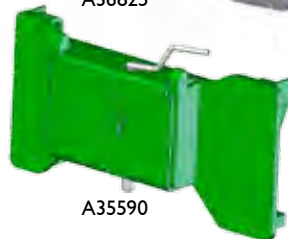

A35590



A412129

# Multi Connector System



Multi connector  
Pressure-Return  
65251



Multi connector  
Pressure-Tank line  
65371



Multi connector  
Pressure-Return-Tank line  
65250



Multi connector  
Loader side  
A34366



Adapter: Multi connector to  
conventional quick couplings  
A414508



Adapter cable for attachment's  
multi connector  
A36679

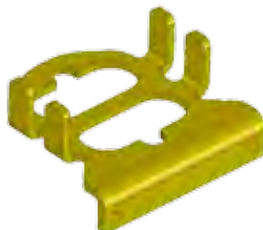

Multi connector  
Parking on attachment  
A418927

## Adapter plate, weld-on

Avant offers a variety of original adapter plates, which can be welded directly onto:

- An attachment you have developed yourself.
- An object you wish to lift securely with Avant

All original Avant adapter plates will fit, which saves a lot of time consuming measuring and adjusting work from you.



Model	Product no
Quick attach brackets	A31566
Quick attach brackets HD	A37015
Adapter plate 10 mm	A2471
Adapter plate 20 mm	A2472

220	225	225LPG	313S	320S	320S+	420	423	520	523	525LPG	528	530	R20	R28	R35	630	635	640	745	750	755i	760i	e5	e6	



# Filter kits



Product no.	Model
A46682	216
A46683	218 / 220 series I ja 2
A420536	225
A44494	Multi 13 hp, Profi 11/13 hp, 313 / 313 S
A44495	Multi diesel/Power diesel/Profi diesel/314, 320, 320+
A45855	314S, 320S, 320S+, manufactured 08/2002 - 10/2004
A46871	314S, 320S, 320S+ manufactured 10 / 2004 - 1 / 2011 serial numbers before XXXXX1104
A414036	320S / 320S+ manufactured 1/2011-, serial numbers after XXXXX1105
A44738	513, manufactured after 06 / 2001
A44493	Multi Plus
A44492	514, 520, 520+, manufactured 2000 - 06 / 2001 serial numbers: 23721 - 24862
A44739	514, 520, 520+, 523+, manufactured 06 / 2001 - 08 / 2002 serial numbers: 24865 - 25933
A45854	514, 520, 520+, 523+, manufactured 08 / 2002 - 10 / 2004 serial numbers: 25935 - 44575
A46870	514, 520, 520+, 523+, manufactured 10/2004 - 12/2007
A414863	419
A49572	420 / 520 series 2, serial numbers before xxxxx1324
A416943	420 / 520 series 2, serial numbers after xxxxx1325
A425525	423 / 523
A414037	525 LPG, manufactured 1 / 2011 -
A46112	528+, manufactured before 06 / 2001, serial numbers: 24325 - 24841
A44740	528+ / 530+, manufactured 06 / 2001 - 08 / 2002, serial numbers: 24852 - 25966
A45853	528+ / 530+, manufactured 08/2002-12/2007, serial numbers: 25967-55601
A48036	528 series 2 (2008-), 530, R28, 630 / 635, serial numbers before XXXXX0902
A417231	R20
A 410961	630 / 635 / 640 serial numbers after XXXXX0903, R35
A 410784	745 / 750, serial numbers before XXXXX1518
A 419900	745 / 750, serial numbers after XXXXX1519
A 418900	755i / 760i

# Wheels & tyres



Size	Bolt pattern	Tyre + rim
		Product no:
4.00 x 12	4 x 100	64072
5.00 x 10	4 x 100	63630
5.00 x 10	6 x 100	65412
21 x 8.00-10	4 x 100	64794



Size	Bolt pattern	Tyre + rim	Tyre + rim, Solid Foam fill
		Product no:	Product no:
23 x 8.50-12	4 x 100	64120	-
23 x 8.50-12	6 x 120	65046	66087
23 x 8.50-12	5 x 140	65995	66089
27 x 8.50-15	6 x 120	65019	66078
27 x 8.50-15	10 x 140	65414	66079



Size	Bolt pattern	Tyre + rim	Tyre + rim, Solid Foam fill
		Product no:	Product no:
20 x 8.00-10*	4 x 100	66231	66379
23 x 10.50-12	4 x 100	64618	-
23 x 10.50-12	6 x 120	65048	66085
23 x 10.50-12	5 x 140	65997	66091
26 x 12.00-12	4 x 100	64752	-
26 x 12.00-12	6 x 120	64931	66082
26 x 12.00-12	10 x 140	65739	66083
320/60-12, HD	6 x 120	65028	-
320/60-12, HD	10 x 140	65224	-
320/55-15	10 x 140	65506	-
400/50-15	10 x 140	65958	-



Size	Bolt pattern	Tyre + rim	Tyre + rim, Solid Foam fill
		Product no:	Product no:
18 x 7.50-8	4 x 100	63503	-
20 x 8.00-10	4 x 100	64164	-
20 x 8.00-10*	4 x 100	66252	-
23 x 8.50-12	4 x 100	64160	-
23 x 8.50-12	6 x 120	65045	66086
23 x 8.50-12	5 x 140	65994	66088
23 x 10.50-12	4 x 100	64161	-
23 x 10.50-12	6 x 120	65047	66084
23 x 10.50-12	5 x 140	65996	66090
26 x 12.00-12	4 x 100	64751	-
26 x 12.00-12	6 x 120	64930	66080
26 x 12.00-12	10 x 140	65212	66081
320/55-15	10 x 140	65459	-
400/50-15	10 x 140	66257	-

\*) 200 series 2, 2016-



Size	Bolt pattern	Tyre + rim
		Product no:
26.5 x 14.00-12	6 x 120	65786
26.5 x 14.00-12	10 x 140	65787



Requires 40 mm spacers (5 bolt) on wheel hubs when mounted on 500 and 600 series:

- Spacer kit, 4 pcs A418958 (part no. for one spacer A417486)





# AVANT<sup>®</sup>

AVANT Tecno OY  
Ylotie 1  
33470 YLOJARVI  
FINLAND

Tel. +358 3 347 8800  
sales@avanttecno.com



AVANT has a policy of continuing improvement,  
and retains the right to change specifications without notice.  
© 2018 AVANT Tecno Oy. All rights reserved.

[www.avanttecno.com](http://www.avanttecno.com)